

- INSTRUCTION MANUAL -

# APOLLO TABLE LAMP SHADE

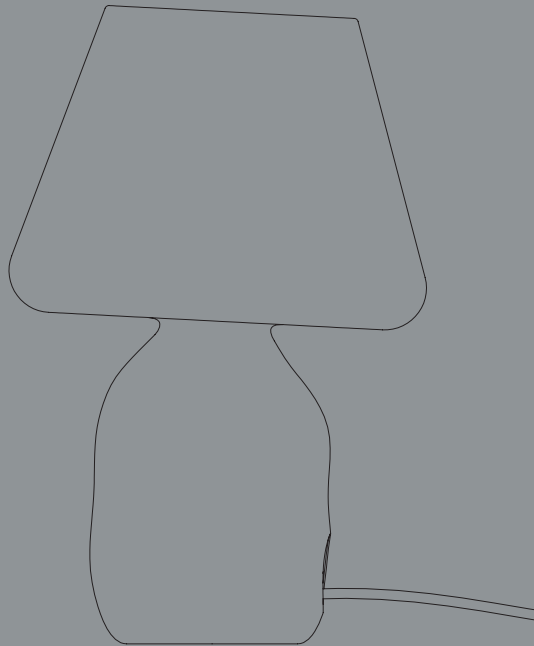

DESIGN BY STUDIO 0405

**HAY**



## - GENERAL INFORMATION -

### TECHNICAL DATA

This product is designed to be used in conjunction with the HAY Cord Set Table, or a similar cord set. HAY recommends using this product with a LED bulb.

FITTING TYPE | LED E27 (EU) or LED E26 (US)  
POWER (W) | 5-15 W  
COLOUR TEMPERATURE | Warm White.

HAY will not accept any responsibility for any accidents or injuries that occur due to the use of incorrect bulbs.

### ATTENTION

Ensure that the power supply to the circuit has been turned OFF before installing the product. In some countries, electrical installations must be carried out by an authorised electrician/contractor; please check with your local authority for guidance.

The product must not be modified in any way. HAY accepts no responsibility for any products that have been modified or tampered with. This lamp is designed for indoor use only.

NOTE | The cord set for the lamp is sold separately and are not supplied with a bulb. If you are using this shade in conjunction with the HAY

Cord Set Table, please follow the instructions that have been provided with it for safe installation.

- The Apollo Table Lamp Shade is designed to be used with LED based light sources only.

### CARE AND MAINTENANCE

The product can be cleaned with a soft damp cloth and mild detergent, or a dry microfibre cloth. Do not use alcohol or any other solvents to clean the product and avoid using abrasive or rough sponges. Ensure that the power supply has been turned OFF before cleaning the product.

- PARTS -

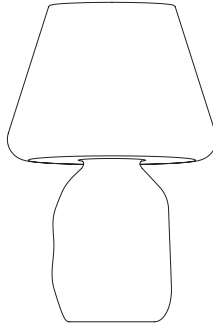

Shade



Bulb holder cork plug



LED Bulb (not included)

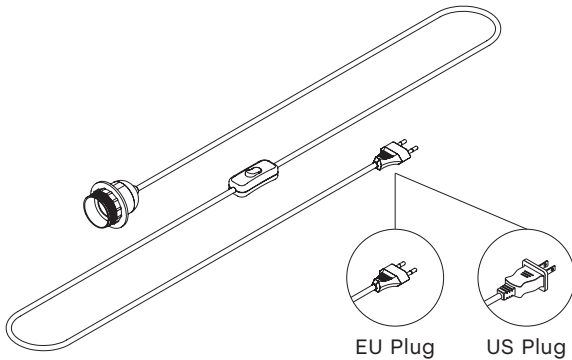

Cord Set (not included)

1.

Unpack all the parts and check that you have received all the parts listed. Carefully unpack the glass shade.

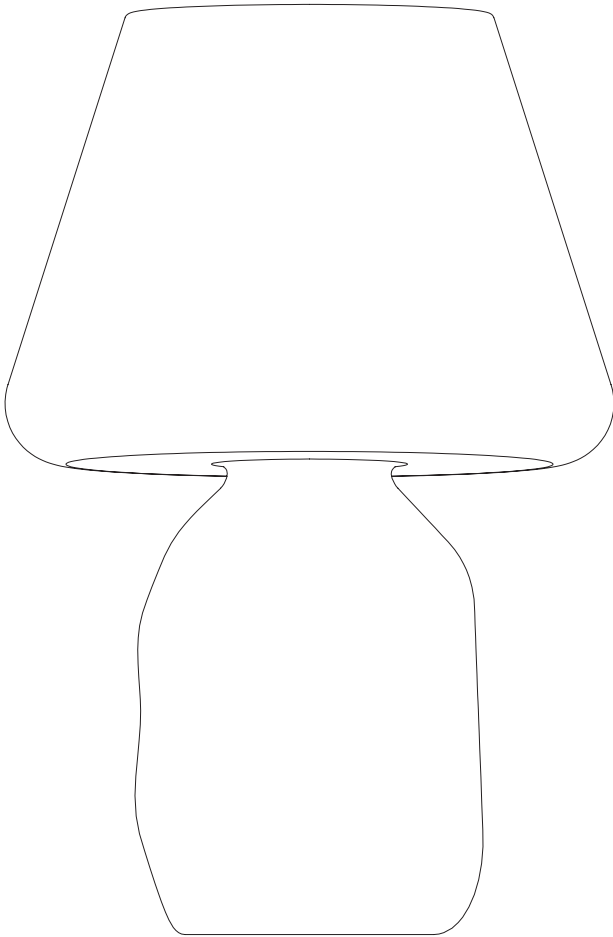

2.

Screw an E27 (EU) or an E26 (US) LED bulb into the bulb holder. Then pass the cable of the cord set through the slot on the cork plug and place the cork plug around the bulb holder, as shown below.

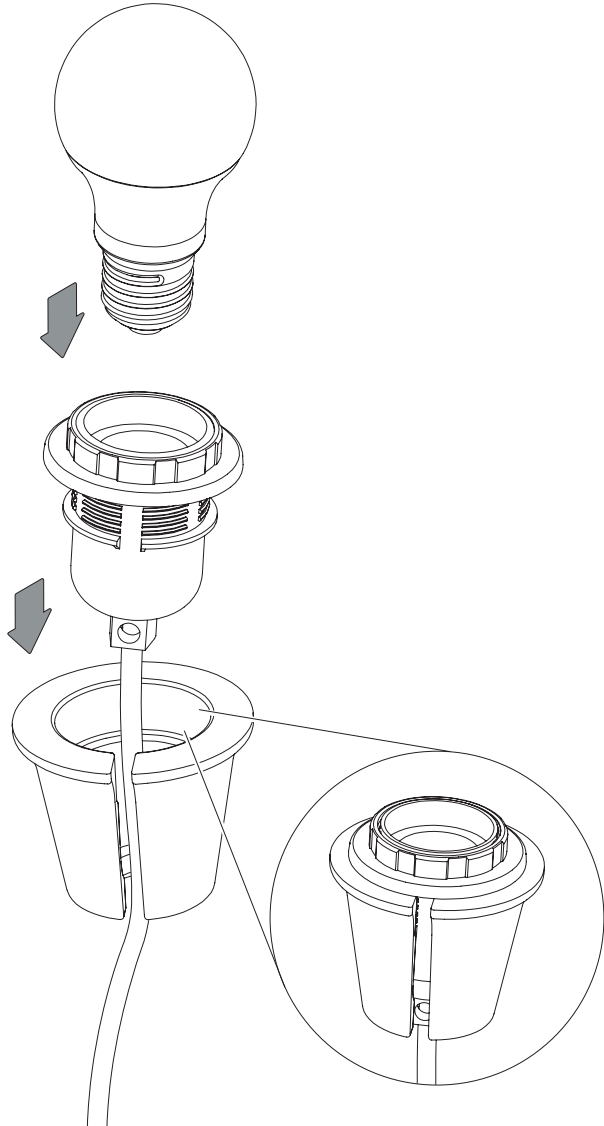

3.

Carefully insert the cable into the glass shade, pulling it through the hole in the base. Place the cork plug, with the bulb holder, into the neck of the glass shade and make sure it is firmly in place.

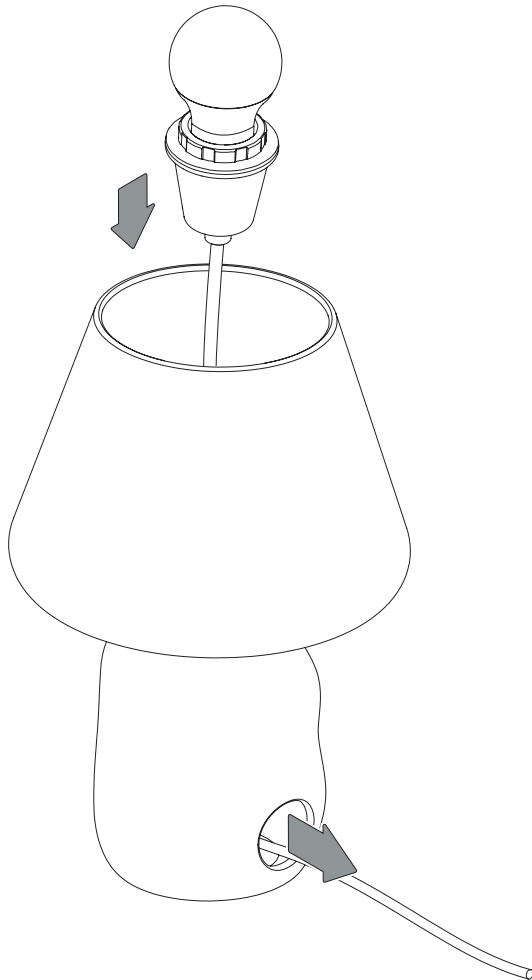

4.

Plug the cord set into the power outlet. The lamp is now ready to use.

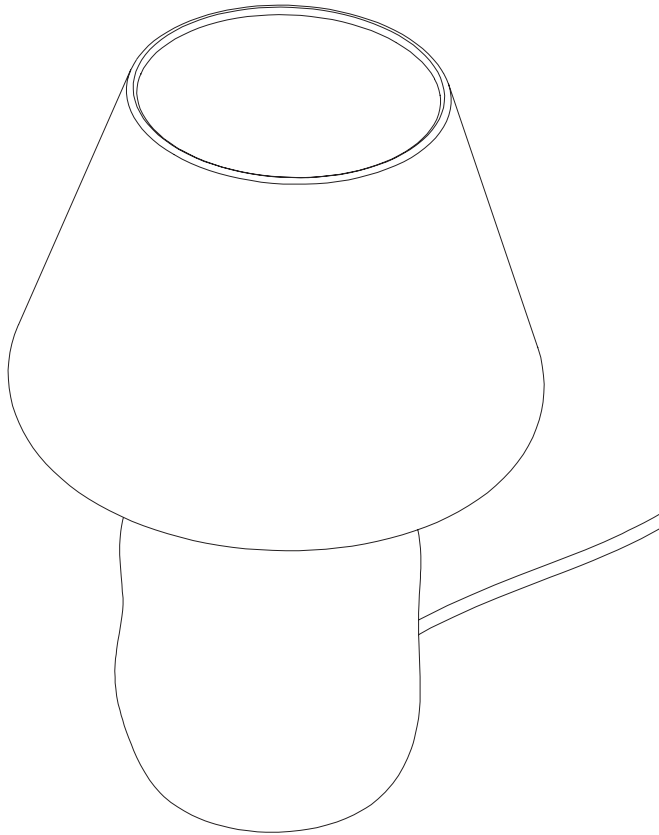



- CARE & MAINTENANCE -

Our Care & Maintenance offers guidance for optimal maintenance of your HAY product. It includes advice and instructions on cleaning and caring for specific materials to prolong the life of your lighting.



Please find our Care & Maintenance guide by scanning the QR code



You can find more relevant information on Apollo Table Lamp Shade by scanning the QR code

You can also find the same information here  
[hay.dk/downloads](http://hay.dk/downloads)





Havnen 1 8700 Horsens Denmark  
+45 4282 0282 / hay@hay.com

[www.hay.com](http://www.hay.com)

06/01/2022

**HAY**